

HFES 2010 HUMAN FACTORS AND ERGONOMICS SOCIETY 54th ANNUAL MEETING

SEPTEMBER 27 - OCTOBER 1, 2010

ALL BOOTHS 10'X10' UNLESS OTHERWISE NOTED.

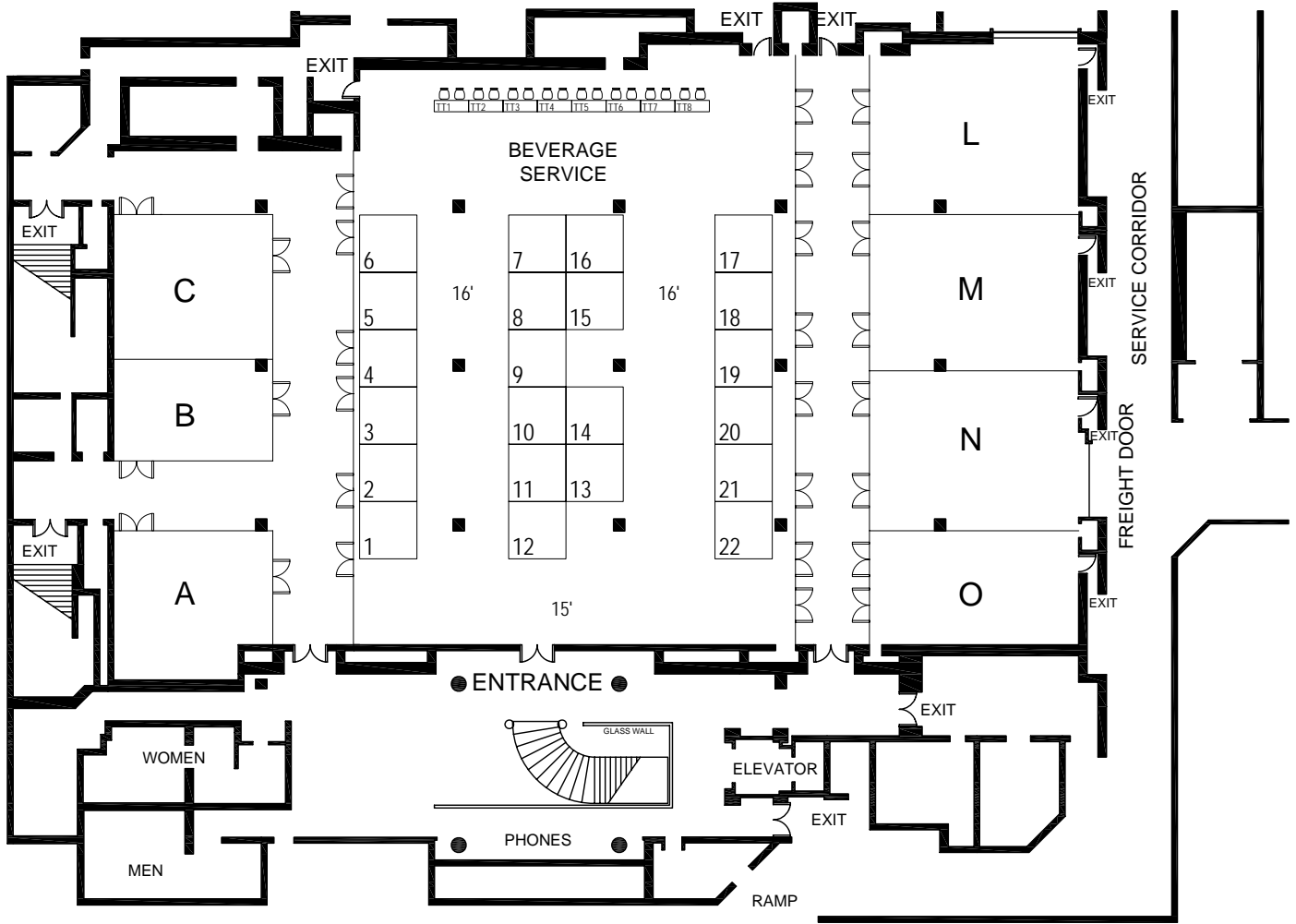

PACIFIC CONCOURSE -D,E,F,G,H,I,J,K
HYATT REGENCY
5 EMBARCADERO CENTER
SAN FRANCISCO, CA.

SCALE

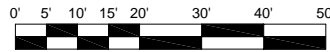

Inventory as of 12/17/2009 11:42am

0% - 0 SqFt Rented
100% - 2,296 SqFt Available

Dimension	Size	Qty	SqFt
2'x6'	12	8	96
10'x10'	100	22	2,200
Totals:		30	2,296

PLAN PREPARED BY:

GES.
5560 Katella Avenue
Cypress, CA 90630
PH: 562-370-1500 FX: 562-370-1699

everythingsexposition

SUBJECT TO FIRE MARSHAL APPROVAL

Copyright © by GES Exposition Services. All Rights Reserved. No part of this publication may be reproduced, stored in any retrieval system, or transmitted in any form by any means - electronic, mechanical photocopying, recording, or otherwise - without the express written consent of GES Exposition Services.

M-0398 SF-00166 12-16-09
D. McDERMID
J. LETCHWORTH